

Controlling an SHX Room with Eyetracking

Using SHX App for Windows. Same for other access methods.
Compatible with SHX Server 1.6 or superior.

1. Use a computer with an installed eye-tracker device.

Type "SHX" in the store or use this link <https://www.microsoft.com/en-us/p/shx/9nwhx2znqlrf>

2. Install in this computer the SHX App for Windows from the Microsoft Store.

3. The computer with the eye-tracker and the SHX App for Windows must be on the same network as the computer with the SHX Server.

4. Configure the Eye-tracker as a mouse.

5. Find the SHX Server's IP address

In the SHX Server, access the server application menu by selecting File -> Settings, Remote app -> Settings...

- Check the File menu is not hidden.
- Press "ALT" to show or hide it.

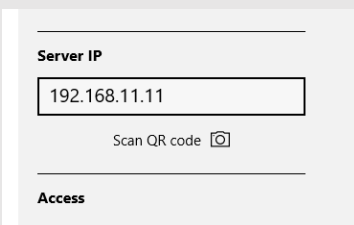
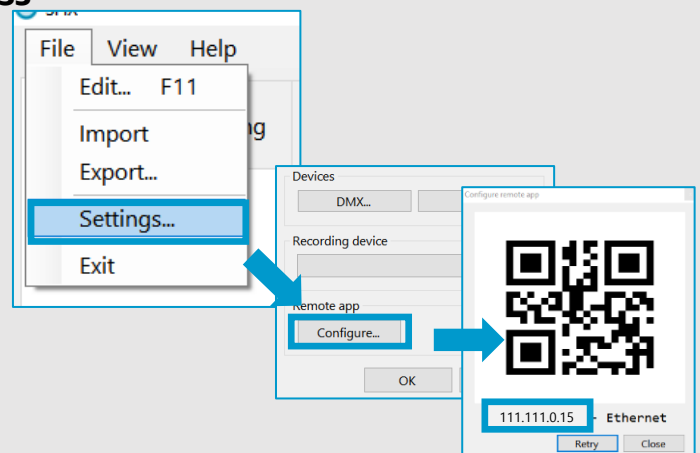

6. Enter the SHX Server's IP address in the SHX App for Windows (ie, the computer with the eye-tracker: Settings -> Server IP)

7. Activate Dwell clicking > Settings -> Access

8. Choose your preferences.

- Rest option
- Time
- Color

